

## Long Banquet Tables – Not to Scaled

1.140 guests

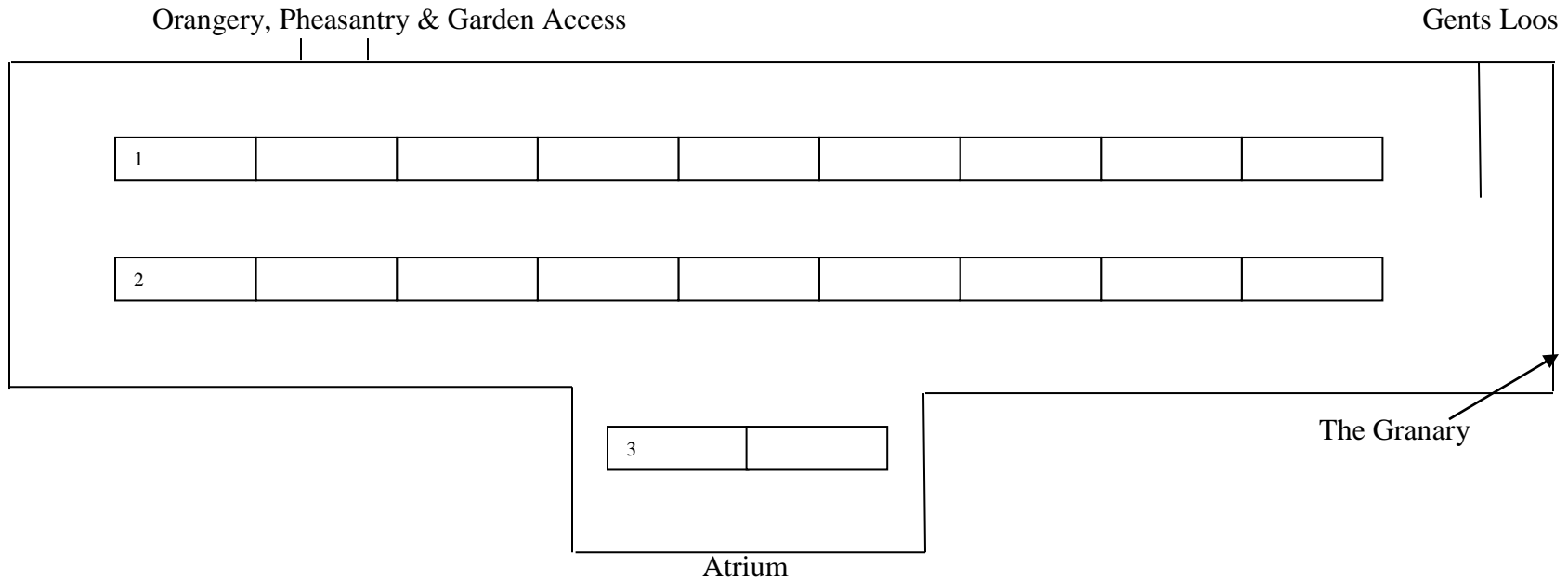

Table 1 – 9 x 3ft by 6ft trestle tables – 32 guests one side & 32 guests the other side

Table 2 – 9 x 3ft by 6ft trestle tables – 32 guests one side & 32 guests the other side

Table 3 – 2 x 3ft by 6ft trestle tables – 6 guests one side & 6 guests the other side

If you would like 150 guests 2 x 5ft 6in round tables will need to replace the 2 x trestle tables in The Atrium seating 10 guests on each

2. 104 guests

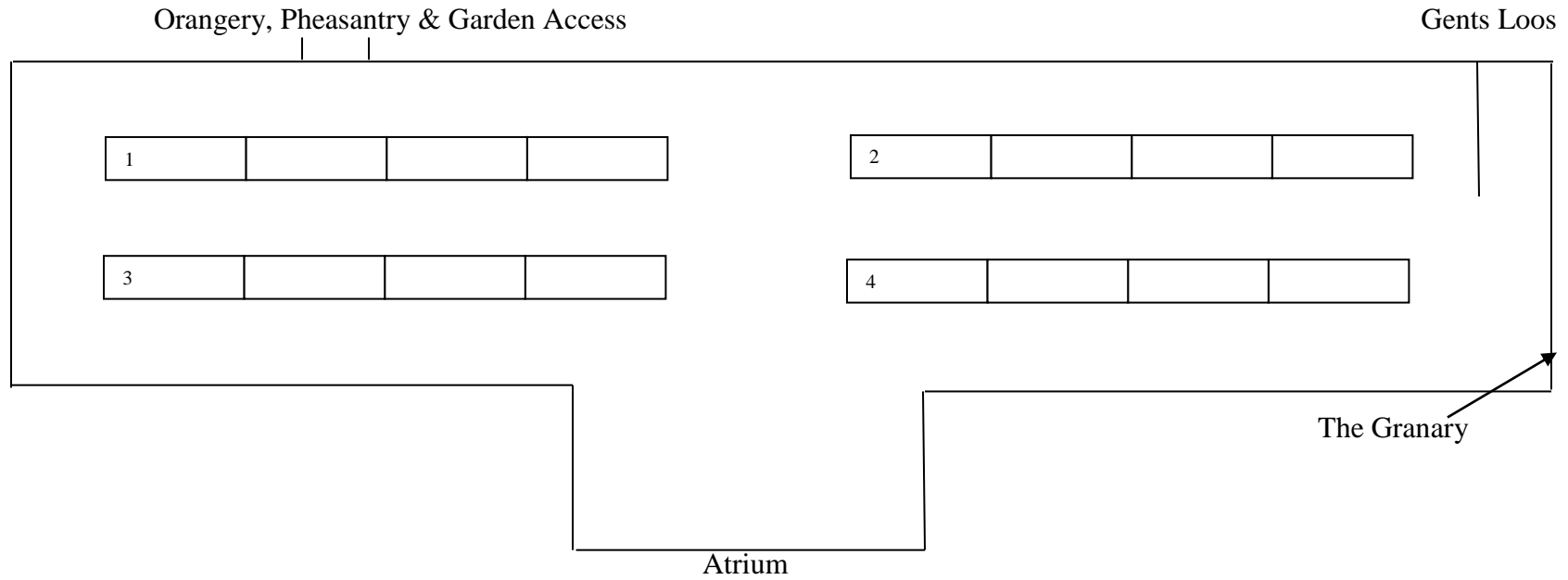

Table 1 – 4 x 3ft by 6ft trestle tables – 13 guests one side & 13 guests the other side

Table 2 – 4 x 3ft by 6ft trestle tables – 13 guests one side & 13 guests the other side

Table 3 – 4 x 3ft by 6ft trestle tables – 13 guests one side & 13 guests the other side

Table 4 – 4 x 3ft by 6ft trestle tables – 13 guests one side & 13 guests the other side

3. 108 guests

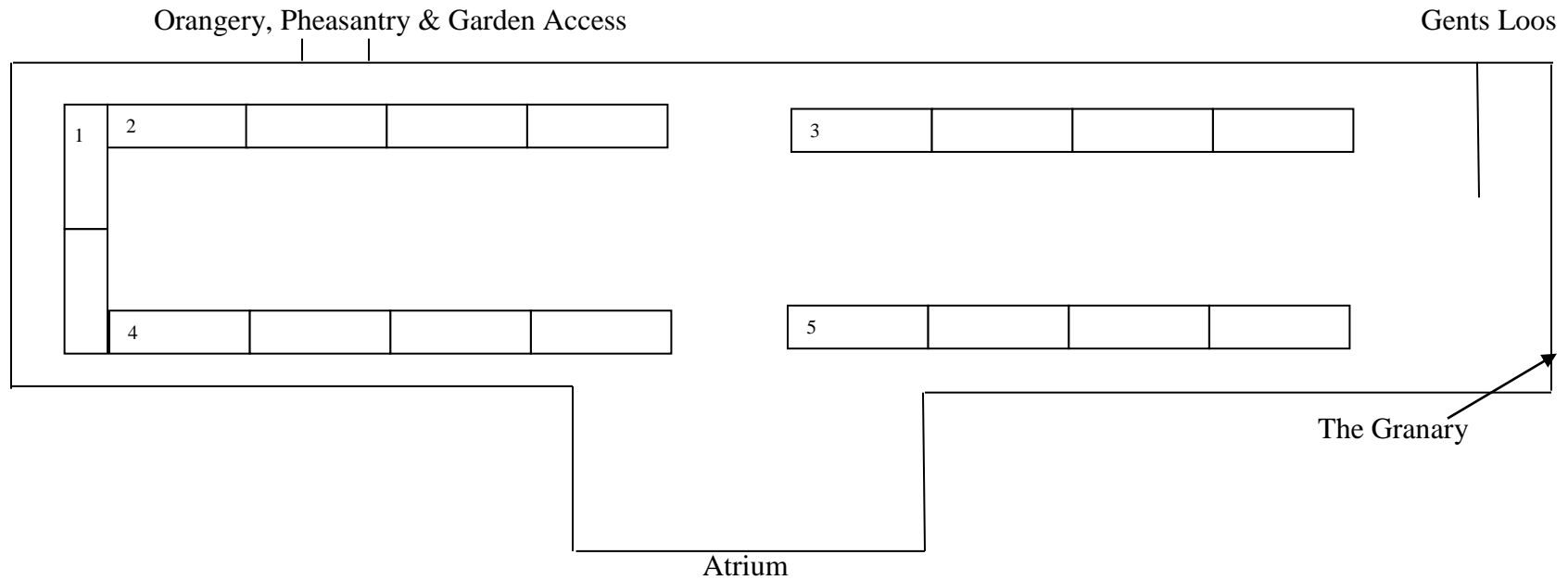

Table 1 – 2 x 3ft by 6ft trestle tables – 6 guests

Table 2 – 4 x 3ft by 6ft trestle tables – 13 guests one side & 12 guests the other side

Table 3 – 4 x 3ft by 6ft trestle tables – 13 guests one side & 13 guests the other side

Table 4 – 4 x 3ft by 6ft trestle tables – 12 guests one side & 13 guests the other side

Table 5 – 4 x 3ft by 6ft trestle tables – 13 guests one side & 13 guests the other side

4. 108 guests

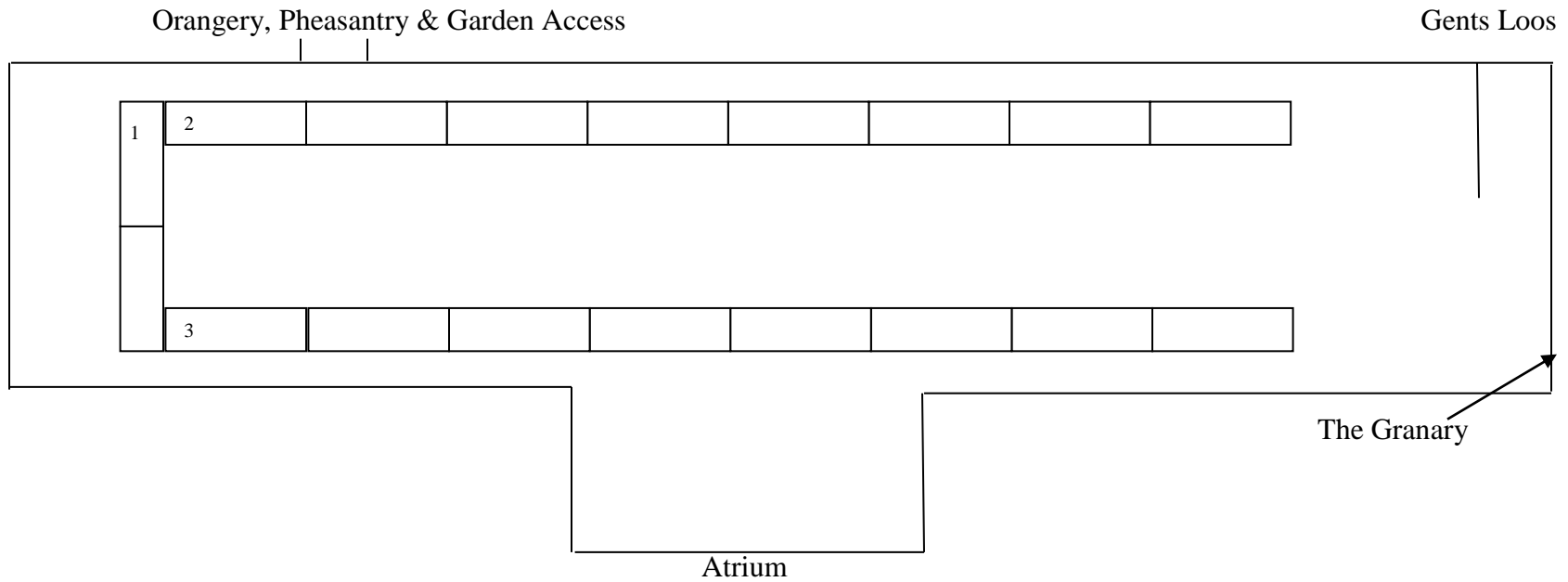

Table 1 – 2 x 3ft by 6ft trestle tables – 6 guests

Table 2 – 8 x 3ft by 6ft trestle tables – 26 guests one side & 25 guests the other side

Table 3 – 8 x 3ft by 6ft trestle tables – 25 guests one side & 26 guests the other side

Total 108 guests

5. 64 guests

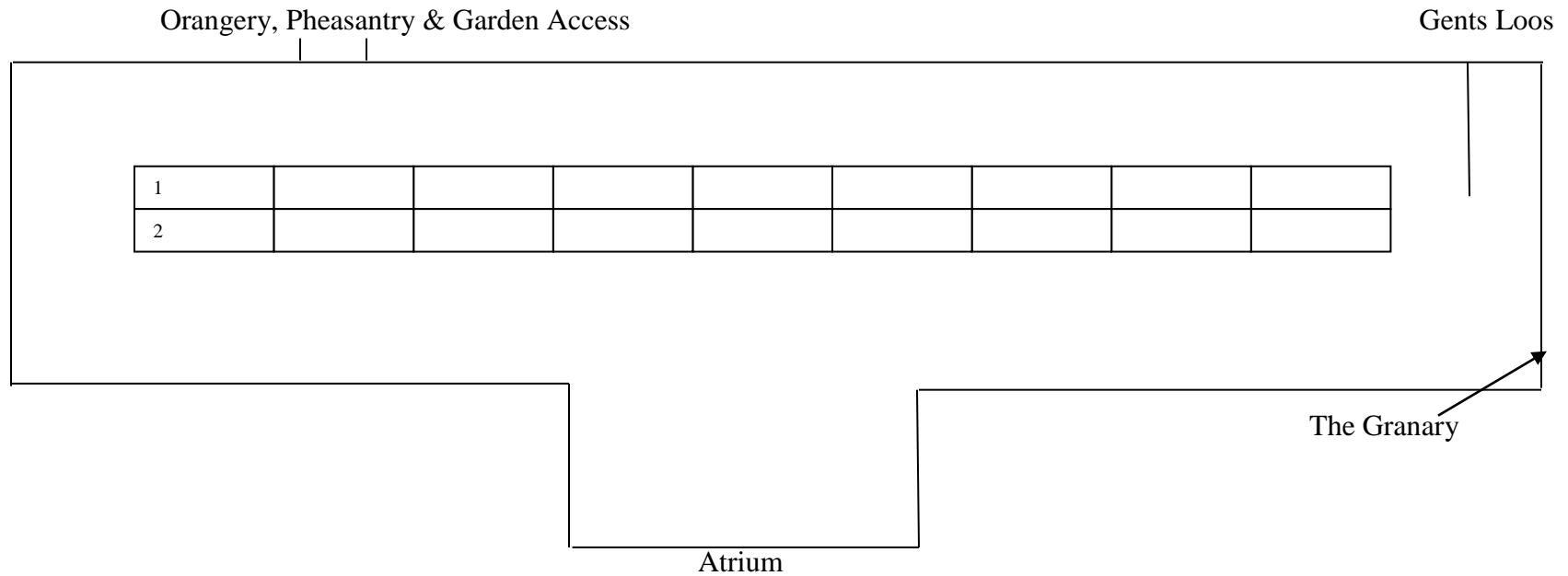

Table 1 – 9 x 3ft by 6ft trestle tables – 32 guests one side

Table 2 – 9 x 3ft by 6ft trestle tables – 32 guests one side

Total 64 guests

\*Please note this works well if you have big and/or wide centre arrangements.

\*\*This number of guests also works well on 1 long table with your guests are not so far apart i.e. just Table 1 on the diagram above with 32 guests and 32 the other.