

## Long Banquet Tables – Not to Scaled

1.142 guests - Maximum

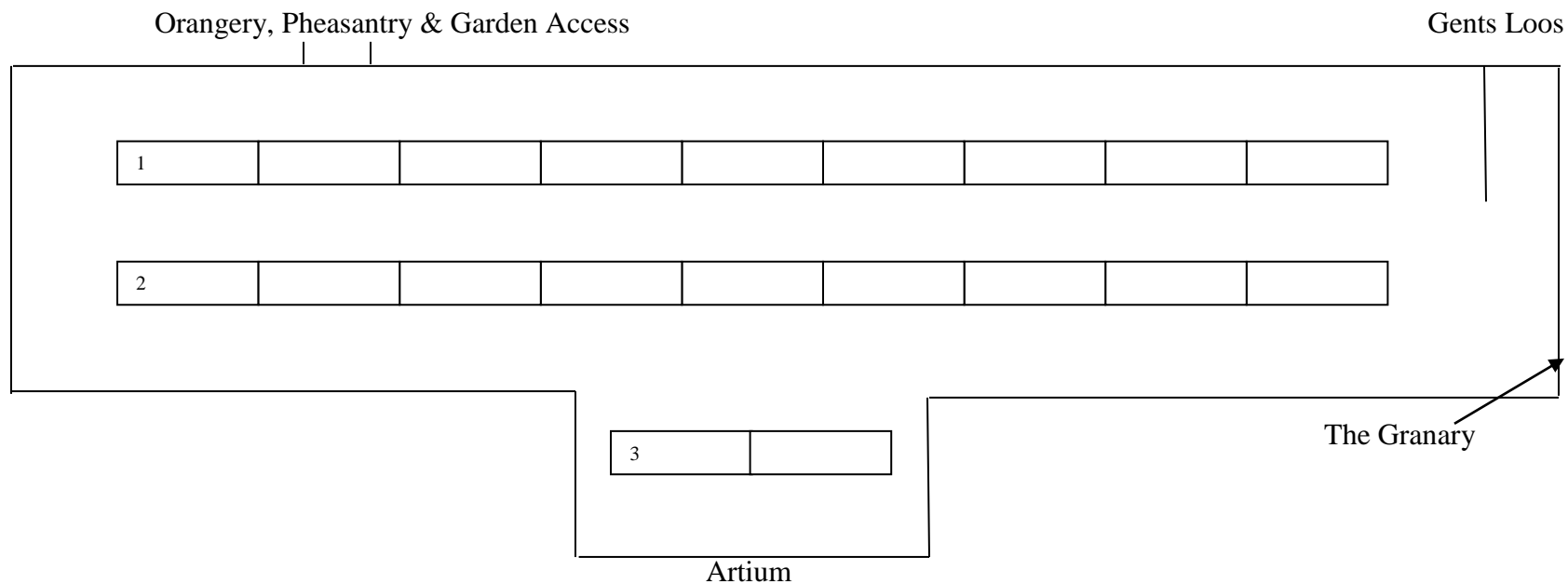

Table 1 – 9 x 3ft by 6ft trestle tables – 33 guests one side & 32 guests the other side

Table 2 – 9 x 3ft by 6ft trestle tables – 33 guests one side & 32 guests the other side

Table 3 – 2 x 3ft by 6ft trestle tables – 6 guests one side & 6 guests the other side

If you would like 150 guests 2 x 5ft 6in round tables will need to replace the 2 x trestle tables in The Atrium seating 10 guests on each

2. 112 guests

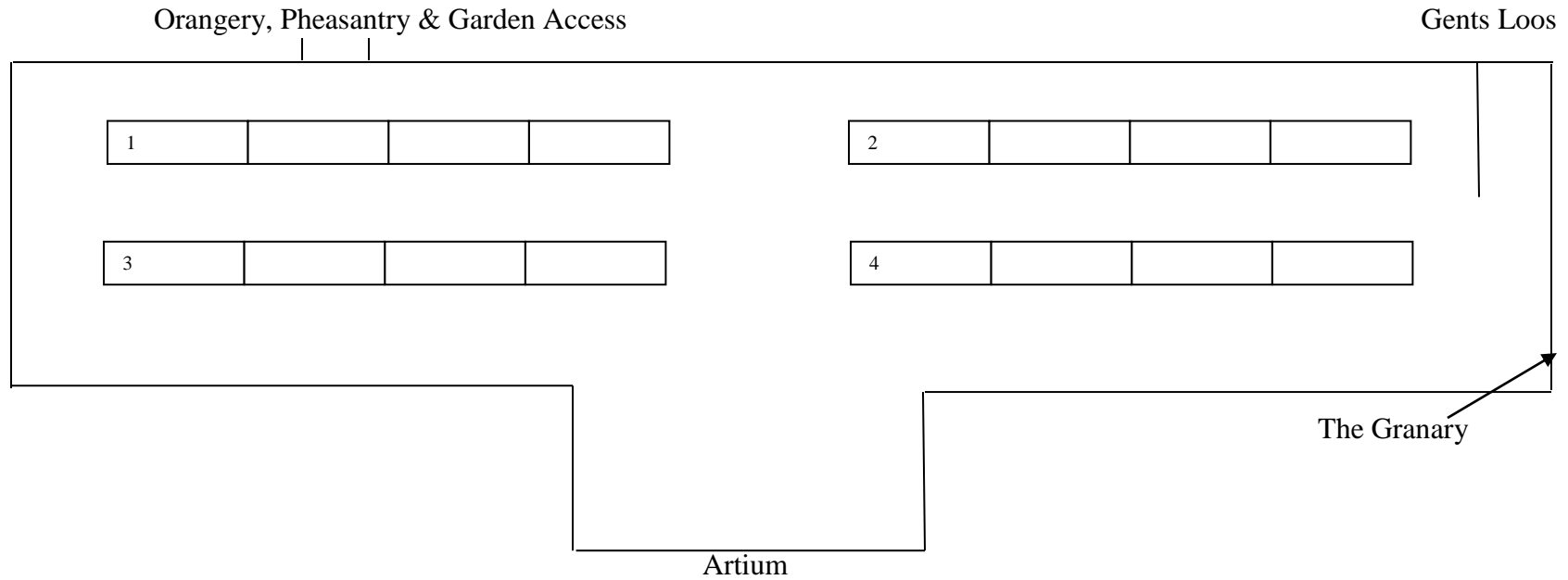

Table 1 – 4 x 3ft by 6ft trestle tables – 14 guests one side & 14 guests the other side

Table 2 – 4 x 3ft by 6ft trestle tables – 14 guests one side & 14 guests the other side

Table 3 – 4 x 3ft by 6ft trestle tables – 14 guests one side & 14 guests the other side

Table 4 – 4 x 3ft by 6ft trestle tables – 14 guests one side & 14 guests the other side

3. 112 guests

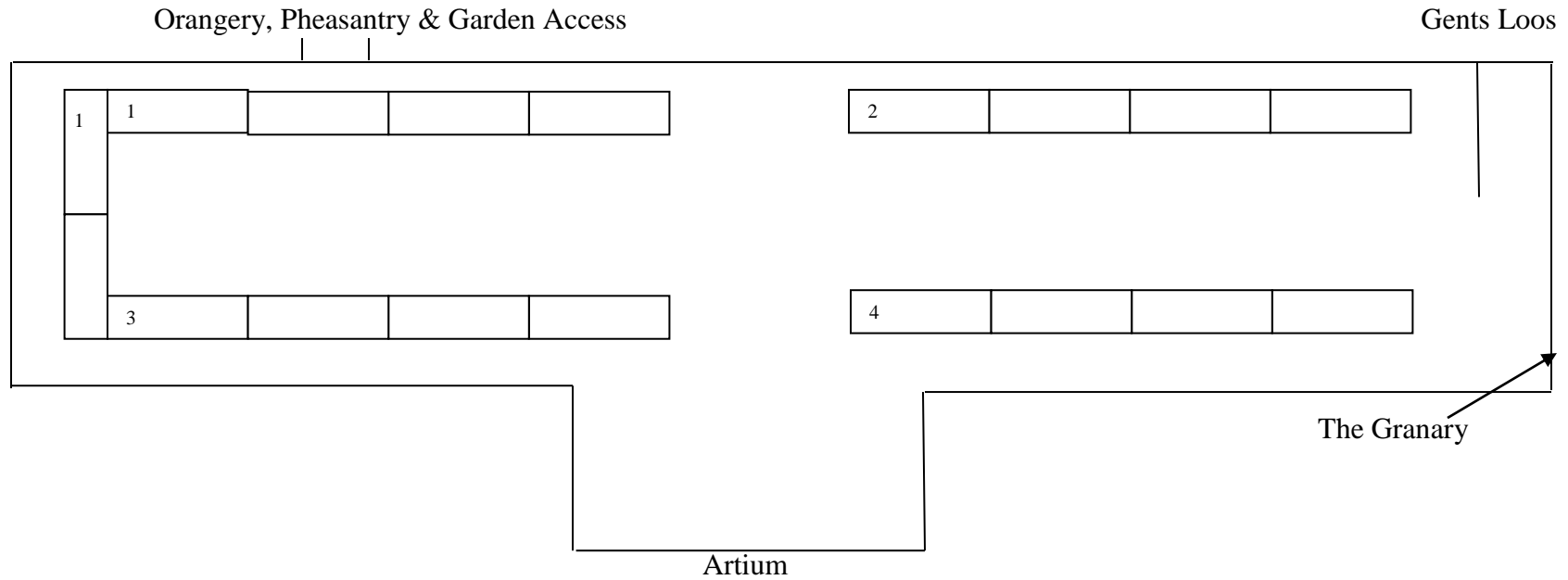

Table 1 – 2 x 3ft by 6ft trestle tables – 6 guests

Table 2 – 4 x 3ft by 6ft trestle tables – 14 guests one side & 11 guests the other side

Table 3 – 4 x 3ft by 6ft trestle tables – 14 guests one side & 14 guests the other side

Table 4 – 4 x 3ft by 6ft trestle tables – 11 guests one side & 14 guests the other side

Table 5 – 4 x 3ft by 6ft trestle tables – 14 guests one side & 14 guests the other side

4. 120 guests

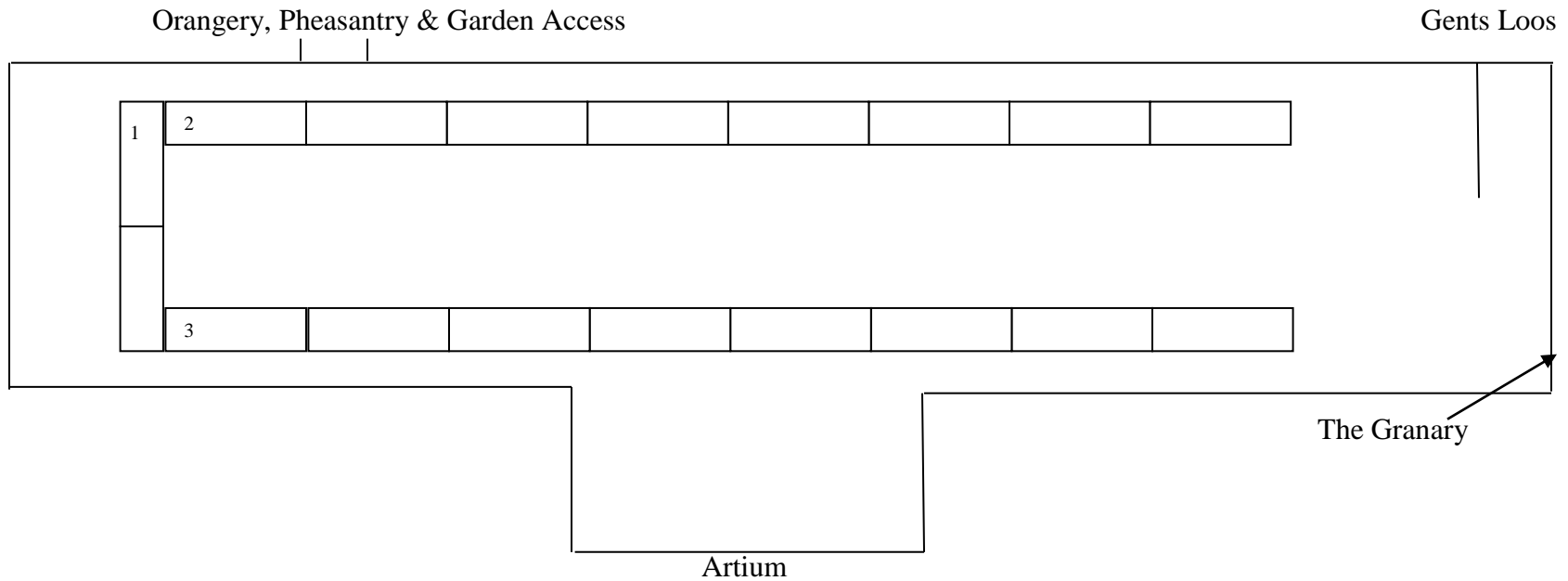

Table 1 – 2 x 3ft by 6ft trestle tables – 6 guests

Table 2 – 8 x 3ft by 6ft trestle tables – 29 guests one side & 28 guests the other side

Table 3 – 8 x 3ft by 6ft trestle tables – 28 guests one side & 29 guests the other side

Total 120 guests

5. 66 guests

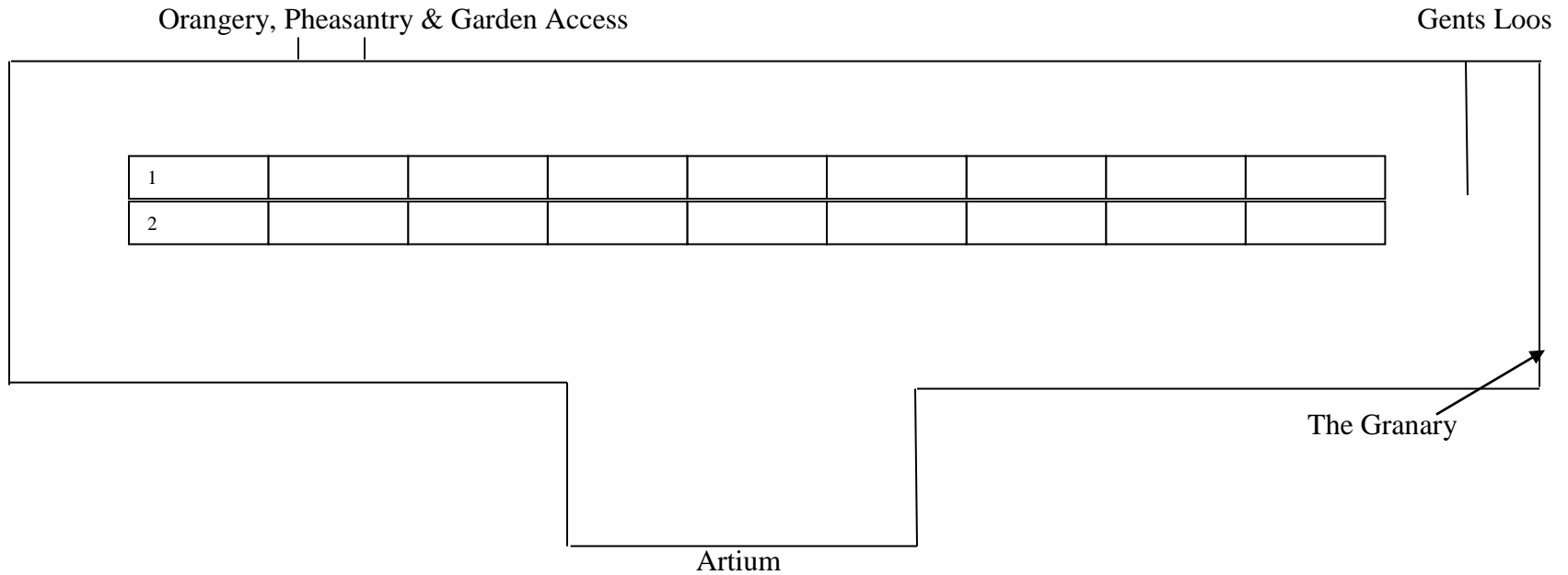

Total 66 guests

\*Please note this works well if you have big and/or wide centre arrangements.

\*\*This number of guests also works well on 1 long table with your guests are not so far apart i.e. just Table 1 on the diagram above with 33 guests and 33 the other.